



"Flip-Top Jar"
means easy access & storage

"Go Nutz"

with

TECHSPAN

INDUSTRIES | INC.

3131 Pepper Mill Court
Mississauga, ON L5L 4X6

Tel: 905-820-6150

Fax: 905-820-6142

sales@techspan.on.ca

www.techspan.biz

Price

Valid 01/15/04-05/30/04

TECHSPAN#			
PART #		U/M	Trade
TN29M	Grey Tech-Nutz	1000 bag	\$ 32.15
TN30M	Blue Tech-Nutz	1000 bag	\$ 40.34
TN31D	Orange Tech-Nutz	500 bag	\$ 21.92
TN33D	Yellow Tech-Nutz	500 bag	\$ 30.75
TN35D	Red Tech-Nutz	500 bag	\$ 47.20
TN29J	Grey Tech-Nutz	500 jar	\$ 18.00
TN30J	Blue Tech-Nutz	350 jar	\$ 15.46
TN31J	Orange Tech-Nutz	500 jar	\$ 24.98
TN33J	Yellow Tech-Nutz	400 jar	\$ 26.85
TN35J	Red Tech-Nutz	250 jar	\$ 25.52
WN734D	Tan Flare-Nutz	500 bag	\$ 60.46
WN735D	Red Flare-Nutz	500 bag	\$ 61.96
WN736D	Grey Flare-Nutz	500 bag	\$ 106.12
WN734J	Tan Flare-Nutz	400 jar	\$ 51.45
WN735J	Red Flare-Nutz	250 jar	\$ 32.91
WN736J	Grey Flare-Nutz	175 jar	\$ 38.48
PC12222D	Red Push-Nutz	500 bag	\$ 49.48
PC12223D	Orange Push-Nutz	500 bag	\$ 58.82
PC12224D	Yellow Push-Nutz	500 bag	\$ 67.43

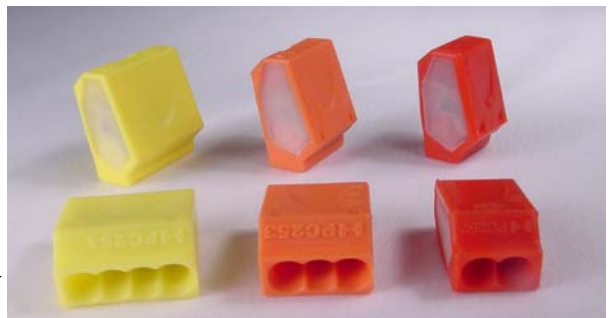

WIRE TERMINATION PRODUCTS

TECH-NUTZ PACKAGE

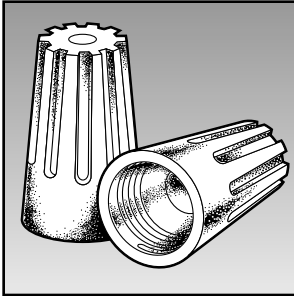

- Color Coded for Easy Identification
- UL Listed – 7B07 and CSA Approved
- Five Sizes for Combinations from #10 through #22
- Rated at 300, 600, or 1000 Volts as noted
- Temperature Rated at 105°C Maximum
- See Wire Combination Charts



Handy
Resealable
Clam Shell
Packaging

Item Number	UL Rating	Color	Packaging
TN29M	300V	Grey	1000/PK (Bag)
TN29C			100/PK (Clam Shell)
TN30M		Blue	1000/PK (Bag)
TN30C			100/PK (Clam Shell)
TN31M	600V	Orange	1000/PK (Bag)
TN31C			100/PK (Clam Shell)
TN33D		Yellow	500/PK (Bag)
TN33C			100/PK (Clam Shell)
TN35CCL		Red	250/PK (Bag)
TN35L			50/PK (Clam Shell)

E

WIRE COMBINATION CHART

Colour	Number
Gray	No. 22 to 16 AWG
	Min. 2 No. 22 Str.
	Max. 2 No. 16
Blue	No. 22 to 14 AWG
	Min. 2 No. 22
	Max. 3 No. 16
Orange	No. 22 to 14 AWG
	Min. 1 No. 18 & 1 No. 20
	Max. 4 No. 16 & 1 No. 20
Yellow	No. 18 to 12 AWG
	Min. 2 No. 18
	Max. 4 No. 14 & 1 No. 18
Red	No. 18 to 10 AWG
	Min. 2 No. 14
	Max. 2 No. 10 & 2 No. 12

WINGED WIRE CONNECTORS

Flare-Nutz

B



LR68461



LISTED
81U0
E113650

Part #	Colour	Wire range/Temperature	Packing
WN7340	Tan	600V /300V Temperature: 105°C #22-#8 AWG Max. 3 #10 Min 2 #22	500/Pack
WN7350	Red	600V /300V Temperature: 105°C #18-#8 AWG Max. 5 #12 Min 2 #16	500/Pack
WN7360	Grey	600V /300V Temperature: 105°C #18-#8 AWG Max. 3 #10 Min 3 #14 w/1 #12	500/Pack

WIRE CONNECTOR SOCKET TOOLS



The sockets have a hex shank design which can fit any pneumatic or electric tool have a 1/4" chuck or drive socket. It is used on screw-on wire connectors for reducing work fatigue and making secure connections.



Part #	Socket Colour	Use for connector part #
TNIT2931	Black	P1-grey, P2-blue, P3-orange, P3H-orange, P4H-yellow
TNIT3335	Black	P4-yellow, P6-red, P6H-red



Part #	Socket Colour	Use for connector part #
WNIT-73456	Black	P11-yellow, P12-tan, P13-red, P15-grey

PUSH-IN WIRE CONNECTORS

Push-Nutz



E113650



Current: 24A (VDE).
Voltage: UL-600V, VDE-450V.
Working Temperature: -30°C to 105°C (-40°F to 221°F).
Housing Material: UL 94V-2 flame retardant thermoplastic.
Wire Range: 12-22 AWG Solid conductor-UL, 2.5mm² Solid-VDE.
Stripping Length: Approx. 11mm /0.45 inches.

Colour coded for easy identification.
Fast, safe, and reliable installation for saving time and cost.
Compact size design perfect for tight spaces.

Part #	Colour	Ports	Wire Range	Voltage	Packing
PC122220	Clear Red	2	12-22 AWG (Solid Cu) 2.5mm ² (Solid Cu)	600V-UL 450V-VDE	500/Pack
PC122223	Clear Orange	3	12-22 AWG (Solid Cu) 2.5mm ² (Solid Cu)	600V-UL 450V-VDE	500/Pack
PC122224	Clear Yellow	4	12-22 AWG (Solid Cu) 2.5mm ² (Solid Cu)	600V-UL 450V-VDE	500/Pack

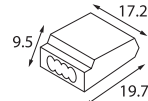
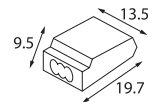
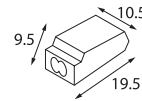

SNAP BUSHINGS



Part #	Mounting Hole Diameter D		Head Diameter B		Inside Diameter A		Overall Height C		Approved UL and CSA	Packing
	Inches	(mm)	Inches	(mm)	Inches	(mm)	Inches	(mm)		
SB0800M	.315	8	.378	9.6	.205	5.2	.327	8.3	Yes	1000Pcs/Bag
SB0950M	.374	9.5	.473	12	.252	6.4	.406	10.3	Yes	1000Pcs/Bag
SB1110M	.437	11.1	.536	13.6	.323	8.2	.406	10.3	Yes	1000Pcs/Bag
SB1300M	.512	13	.595	15.1	.386	9.8	.406	10.3	Yes	1000Pcs/Bag
SB1600M	.63	16	.713	18.1	.508	12.9	.406	10.3	Yes	1000Pcs/Bag

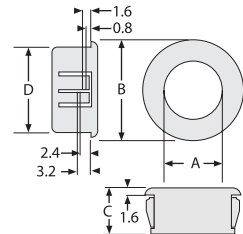

B